

The spots are developed for the use in Wellness areas, especially for steam rooms. They have the protection class IP65. Furthermore the illuminant / light bulb can be changed from the inside of the steam room.

LED spot 55mm
multicolor

Spot LED-RGB IP65
Aluminium - nickel plated, beamless lens.
LED- RGB 3x1 Watt, installation boring 42mm,
cover 55 mm outer diameter.
Mounting sleeve D42x110mm + screw nut
incl. 20 cm connection cable JST.

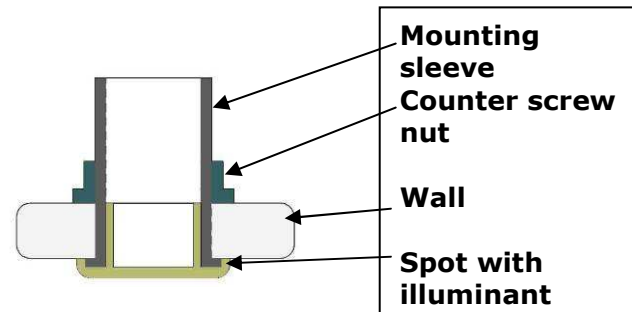

LED spot 55mm diffusion resistant installation
into the steam room
multicolor

Spot LED-RGB IP65
Aluminium - nickel plated, beamless lens.
LED- RGB 3x1 Watt, installation boring 42mm,
cover 55 mm outer diameter.
Mounting sleeve D42x110mm + sealing flange
incl. 20 cm connection cable JST.

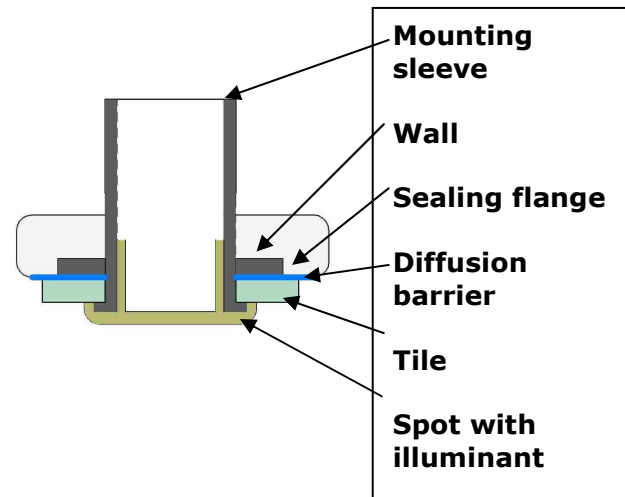

Technical data:

Electrical connection	350 mA
Performance	1 W
Colours	Red-Green-Blue
Installation boring	42 mm
Connection thread	1½"
Weight [kg]	0,150
Installation depth [mm]	117
Diameter of the cover [mm]	55



Subject to change - 2010

Installation of the mounting sleeves for LED spots in GFK / plastic or aluminium ceilings

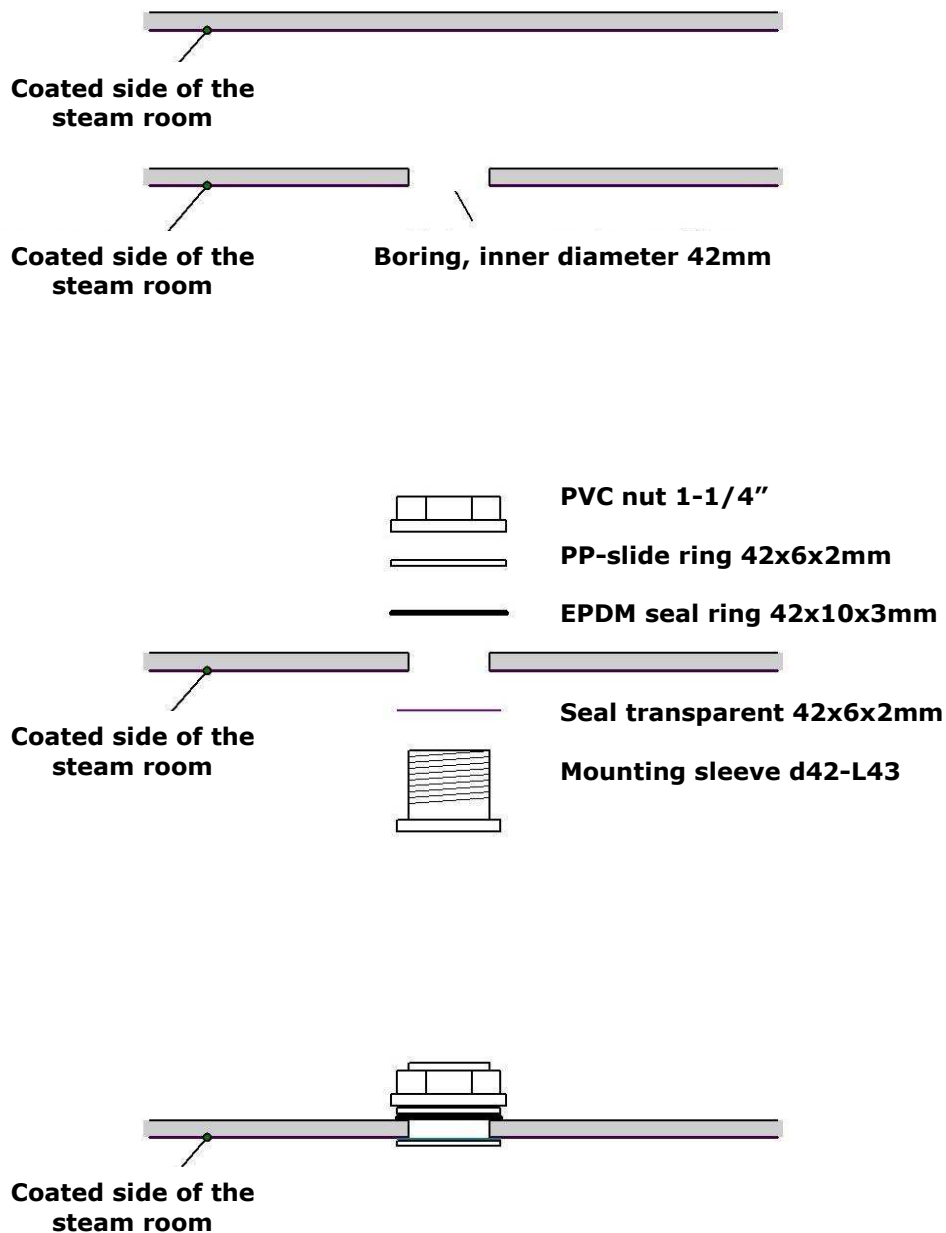

Subject to change - 2010

Installation of the mounting sleeves for LED spots in cavity walls or ceilings

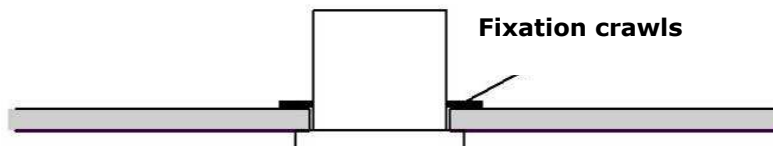
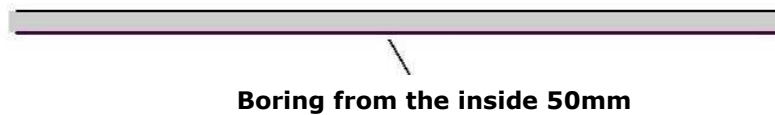

Subject to change - 2010

Installation of the mounting sleeves for LED spots in a coated walls or ceilings

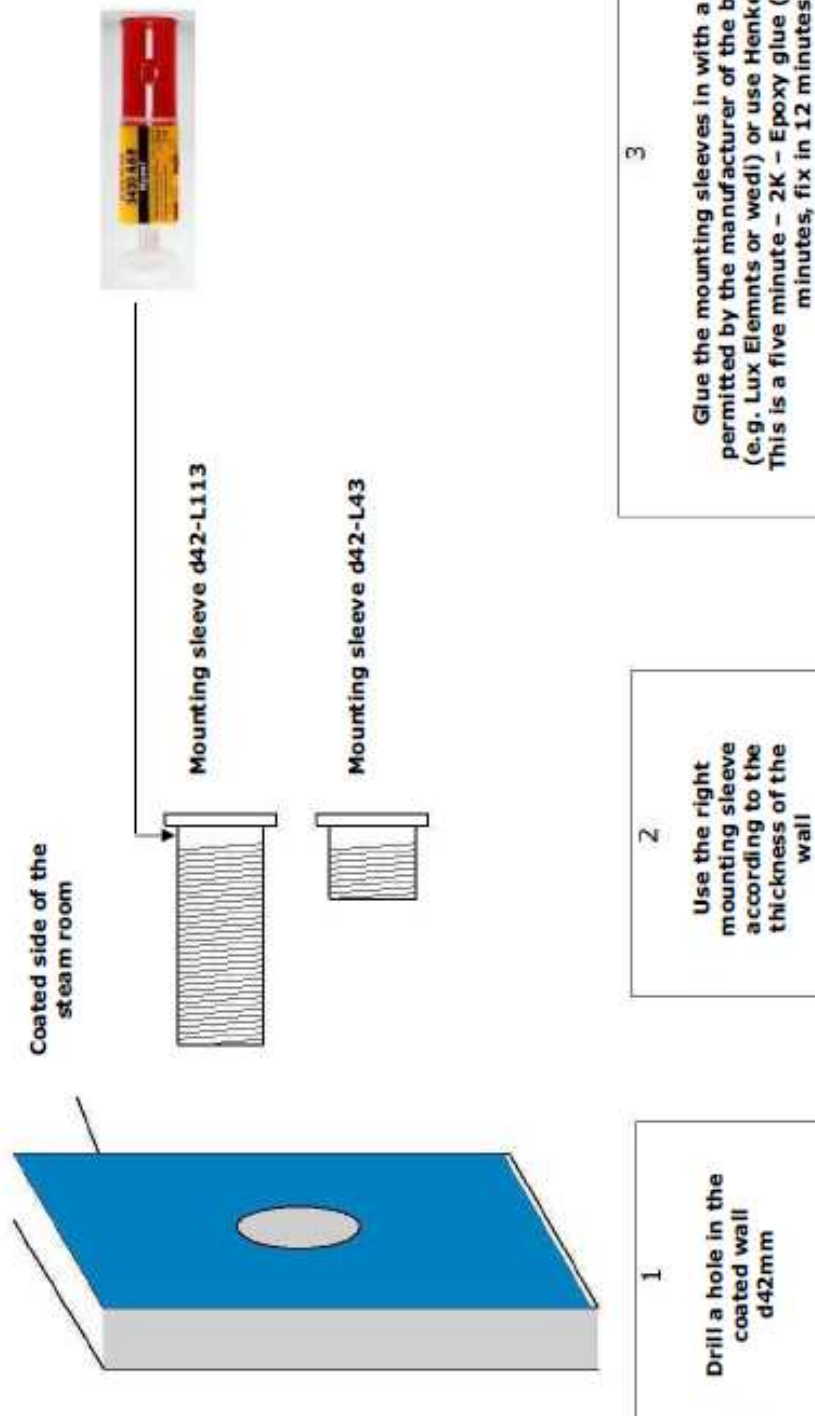

3

Glue the mounting sleeves in with a glue that is permitted by the manufacturer of the building boards (e.g. Lux Elemnts or wedl) or use Henkel Loctite 3430. This is a five minute - 2K - Epoxy glue (working time 4 minutes, fix in 12 minutes).

2

Use the right mounting sleeve according to the thickness of the wall

1

Drill a hole in the coated wall d42mm

Subject to change - 2010

Installation of the mounting sleeves for LED spots in a tiled walls or ceilings

Installation of the mounting sleeves for LED spots in a tiled walls or ceilings

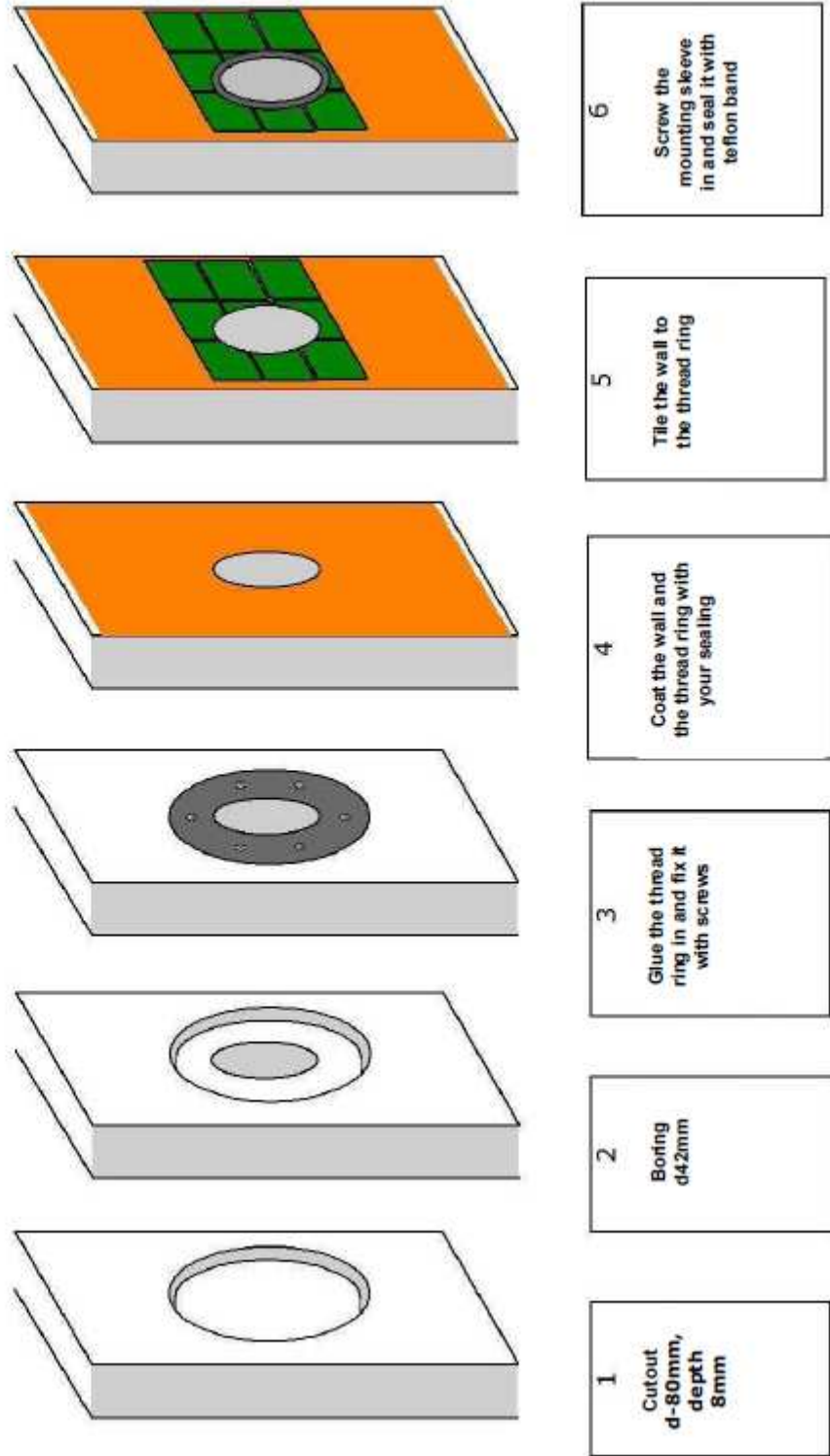

2010

Putting the LED RGB spot into the mounting sleeve

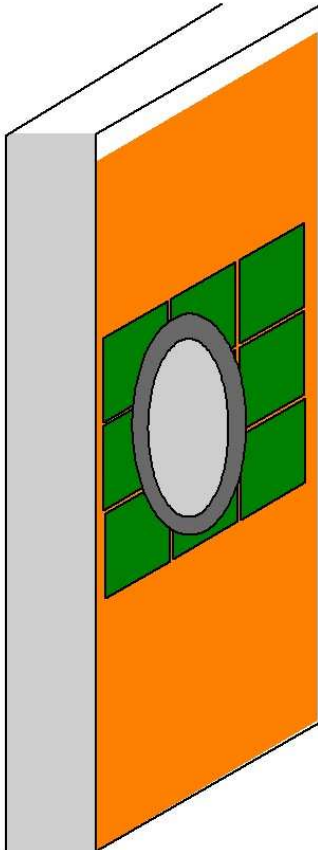

Steam romm wall/ sealing with installed mounting sleeve as described above

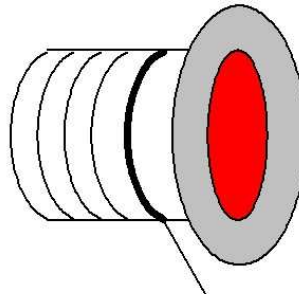

- Grease the incl. O-Ring
- Screw the spot into the mounting sleeve

Subject to change - 2010

SAU controller

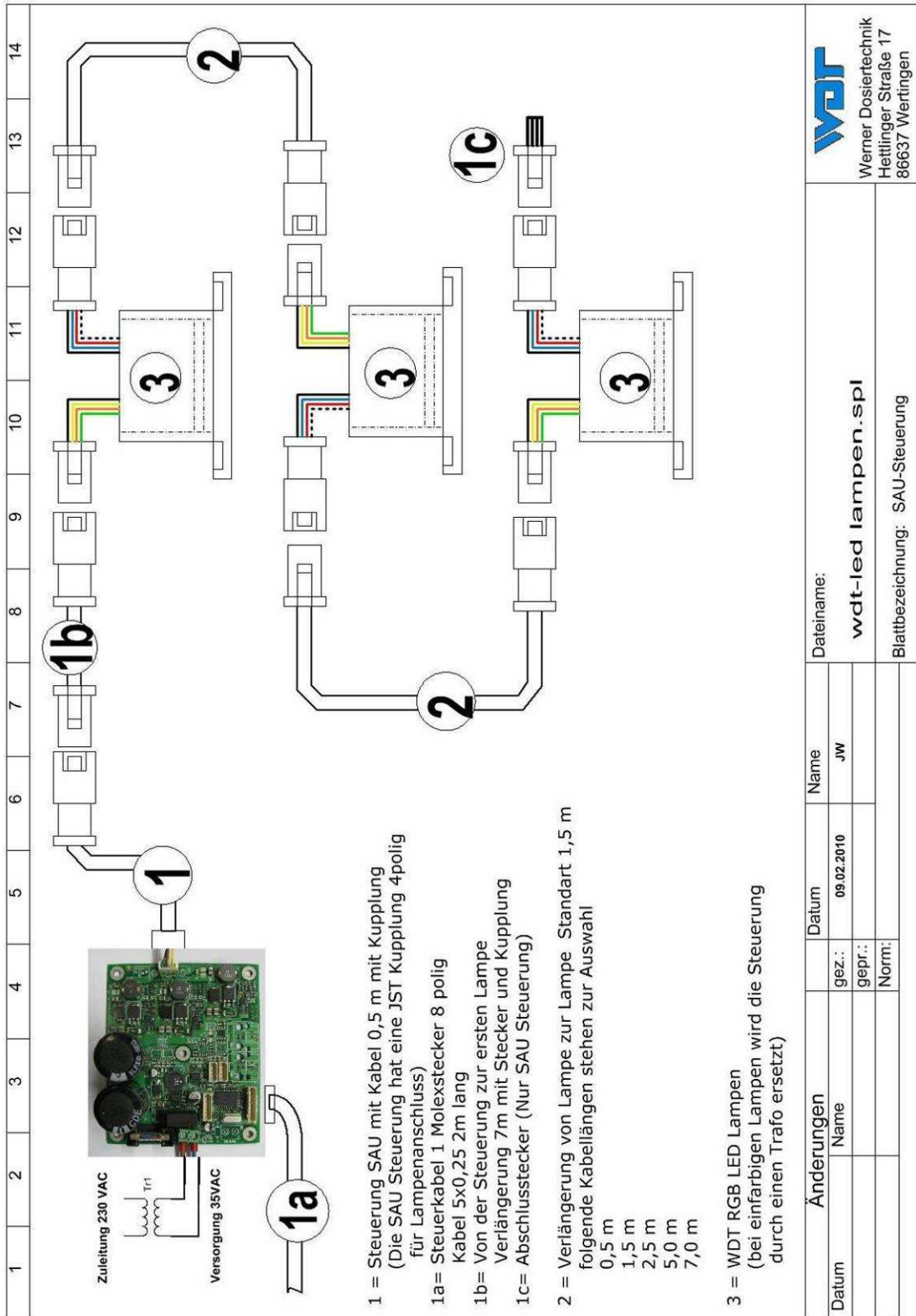

Subject to change - 2010

	<p>Art. Nr.: 20951 LED spot 55 Alu RGB</p> <p>Art. Nr.: 20975 LED spot 55 VA RGB</p> <p>Art. Nr.: 21087 LED spot 55 VA RGB – white light</p>
	<p>Art. Nr.: 20973</p> <p>Mounting sleeve for LED Spots, installation boring 42mm incl.:</p> <ul style="list-style-type: none"> - sleeve D42x113mm - nut 1 1/4" - EPDM seal ring - PP-slide ring - SI sealing
	<p>Art. Nr.: 20971</p> <p>Mounting sleeve for LED Spots, installation boring 42mm incl.:</p> <ul style="list-style-type: none"> - sleeve D42x40mm - nut 1 1/4" - EPDM seal ring - PP-slide ring - SI sealing
	<p>Art. Nr.: 20974</p> <p>Mounting sleeve for LED Spots for tiled rooms, installation boring 42 mm incl.:</p> <ul style="list-style-type: none"> - mounting sleeve D42x100mm - thread ring - 6 screws

Subject to change - 2010